



## SNP Square & Kamenné Square in Bratislava

### The Urban Topography

The spatial relationships between the three inner city squares need to be restored. We would like to create a high-quality, well-organized urban space whose different characters enrich people's lives in Bratislava.

This will be achieved by consistent paving and reduction of road traffic. At the same time, climate-neutral transport systems are promoted. This creates a contemporary urban space that is suitable for today's and tomorrow's needs and at the same time makes history tangible.





1 / 750



1 / 1,500



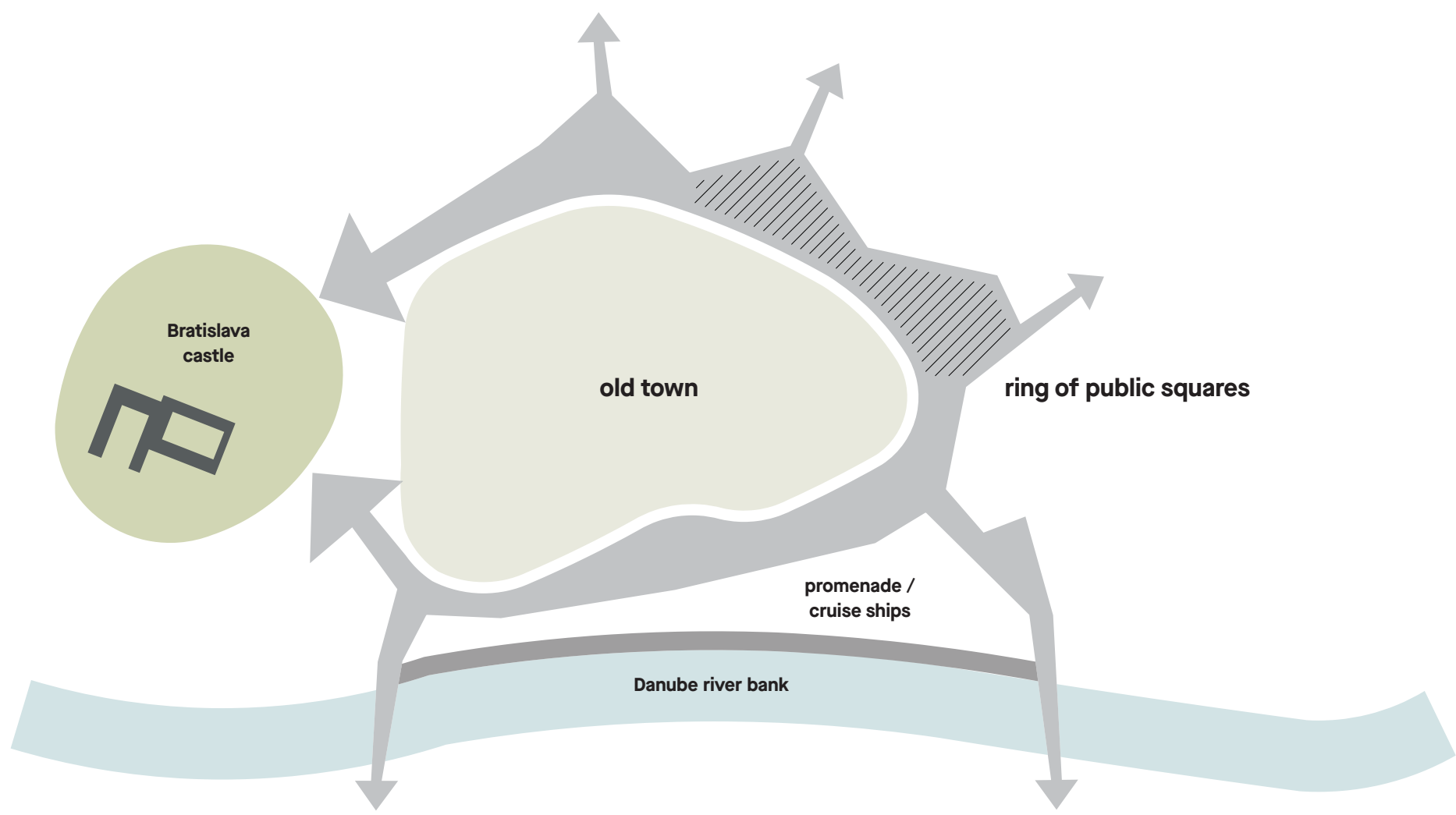

## Historical chance to complete the Old Town Loop

Along the former moat, the edge of the old town is clearly visible. Until now, the urban space in the middle of the city has been used as an oversized traffic area. Now there is a great chance to connect these open spaces to a network of squares. Like a crown, the loop surrounds the city. The attractions of the old town, with its river and castle, take on a new relationship to the neighboring districts and create space for new mobility.

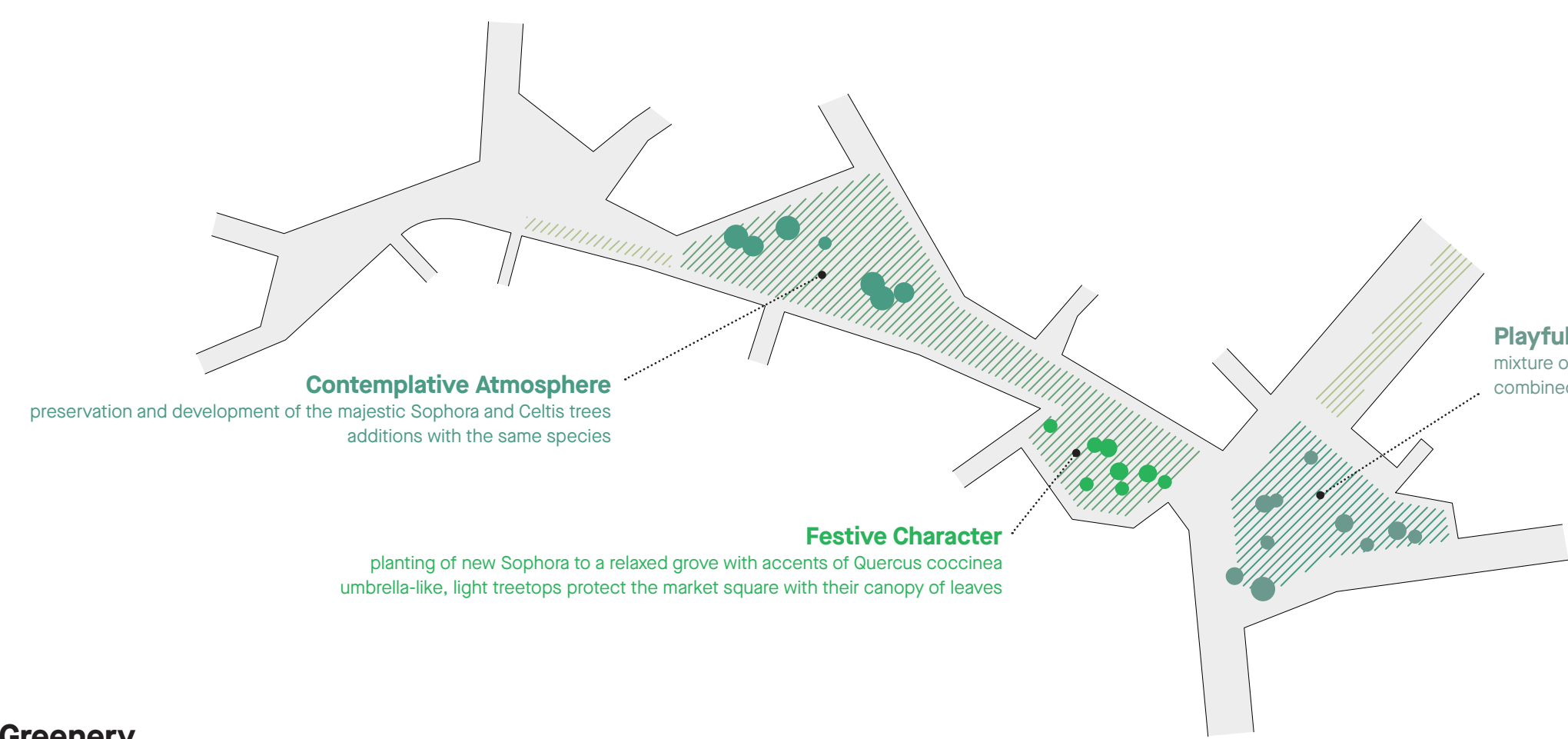

### Greenery

Our planting strategy primarily preserves the existing trees. Additional new plantings bring a playful and dynamic change of texture and flowers. They ensure a lively vegetation texture during the whole year.

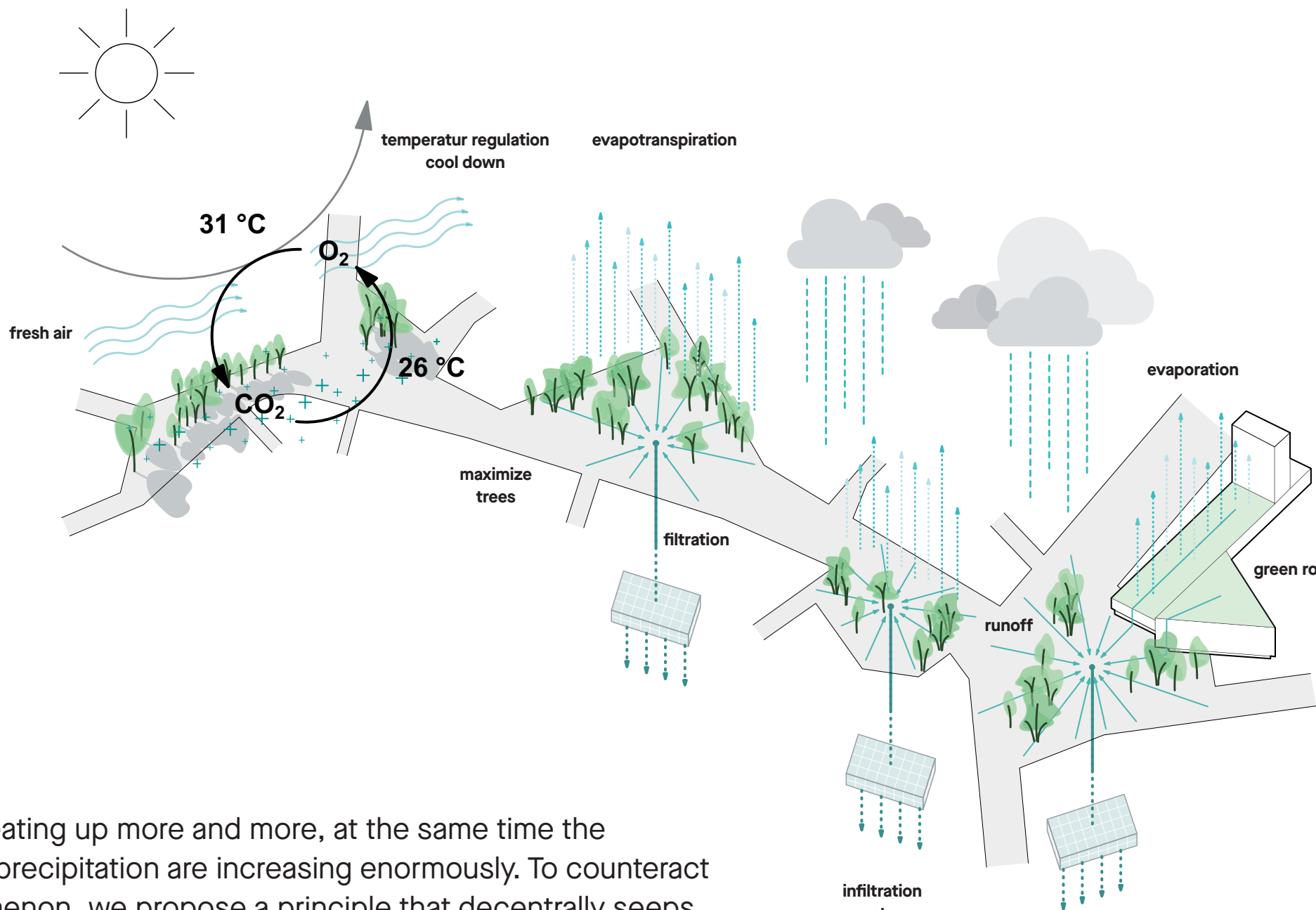

### Climate

Cities are heating up more and more, at the same time the amounts of precipitation are increasing enormously. To counteract this phenomenon, we propose a principle that decentrally seeps away rainwater and boosts the microclimate.

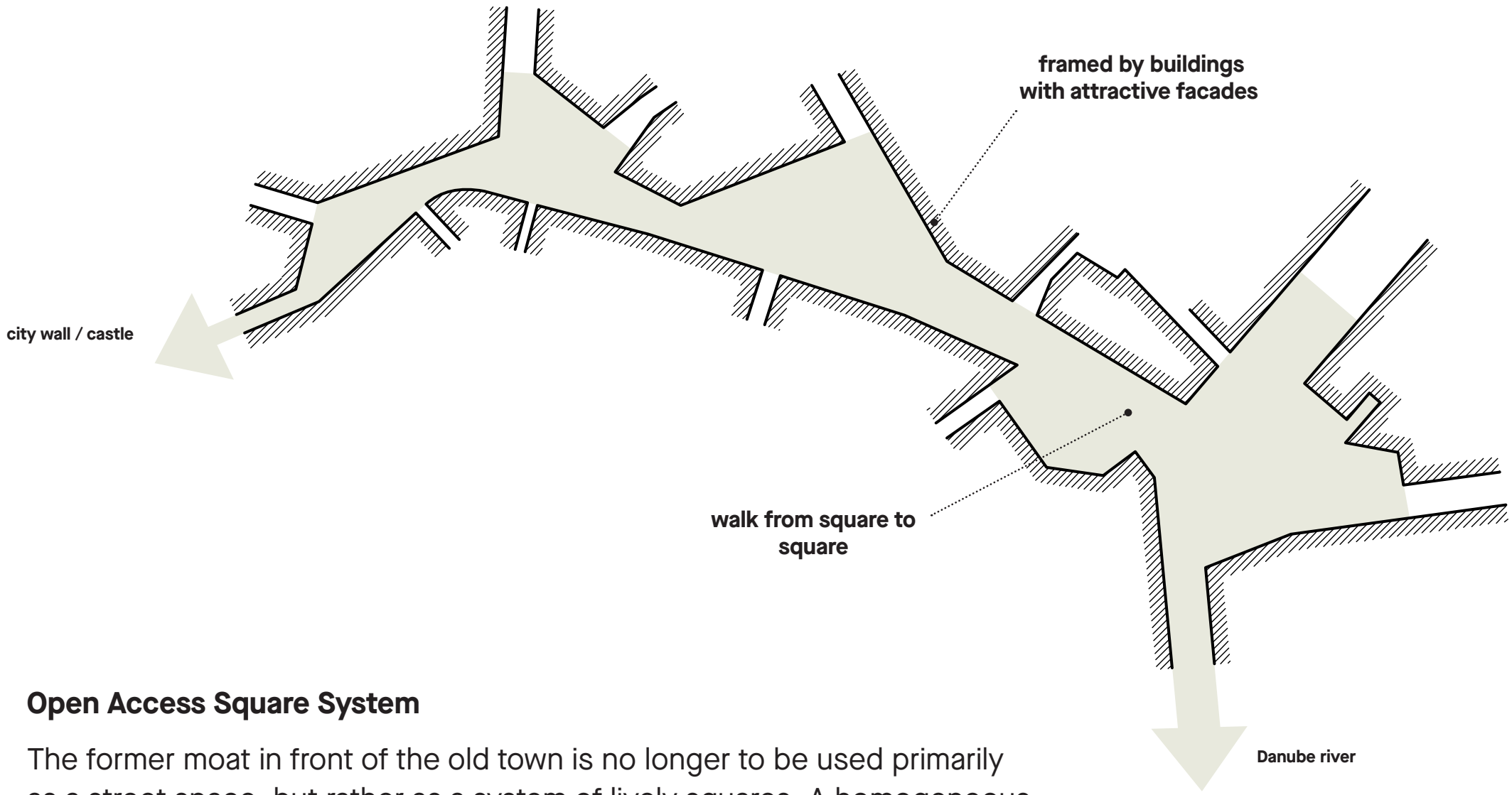
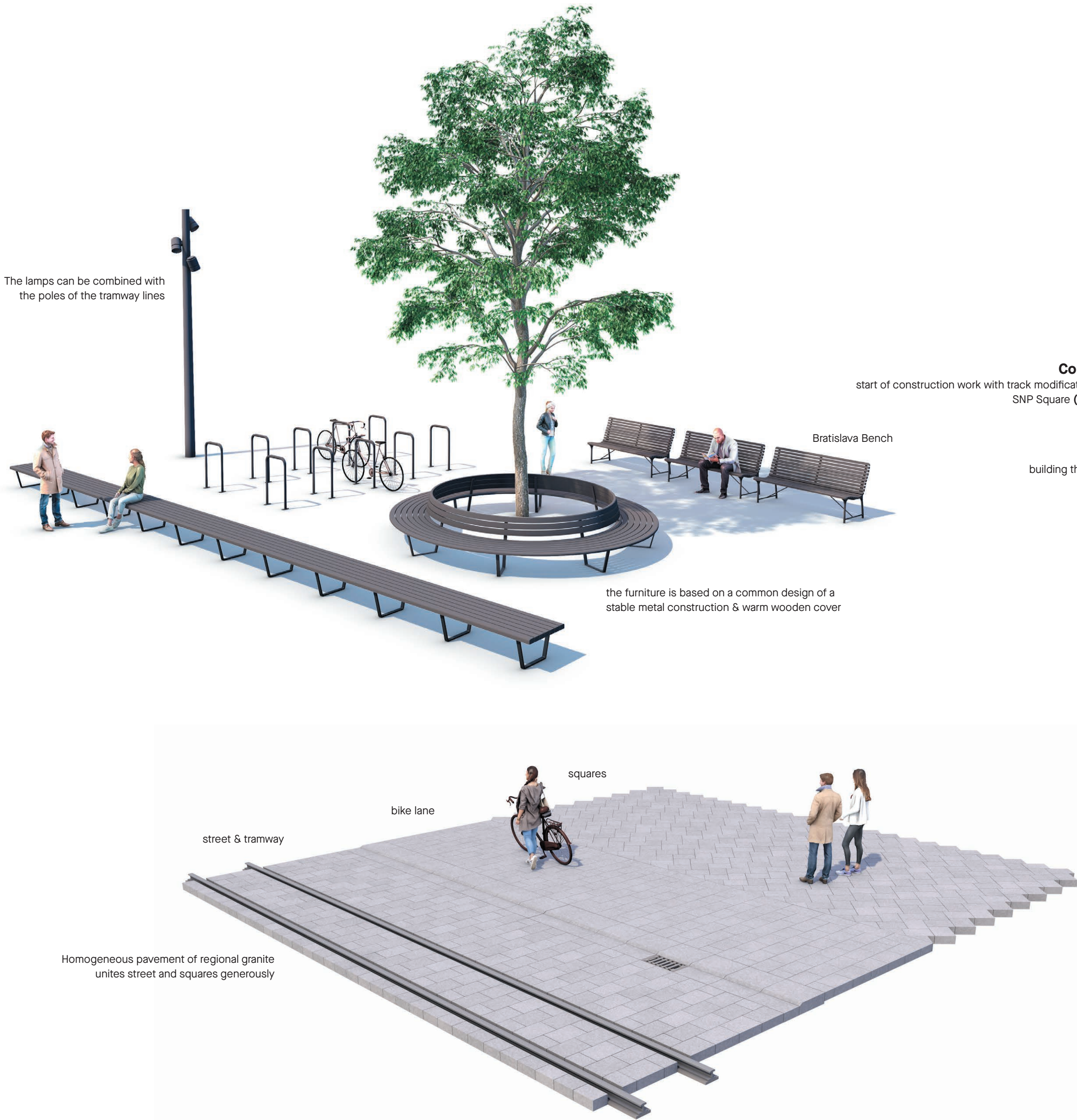

### Open Access Square System

The former moat in front of the old town is no longer to be used primarily as a street space, but rather as a system of lively squares. A homogeneous pavement and furniture unify the sites.

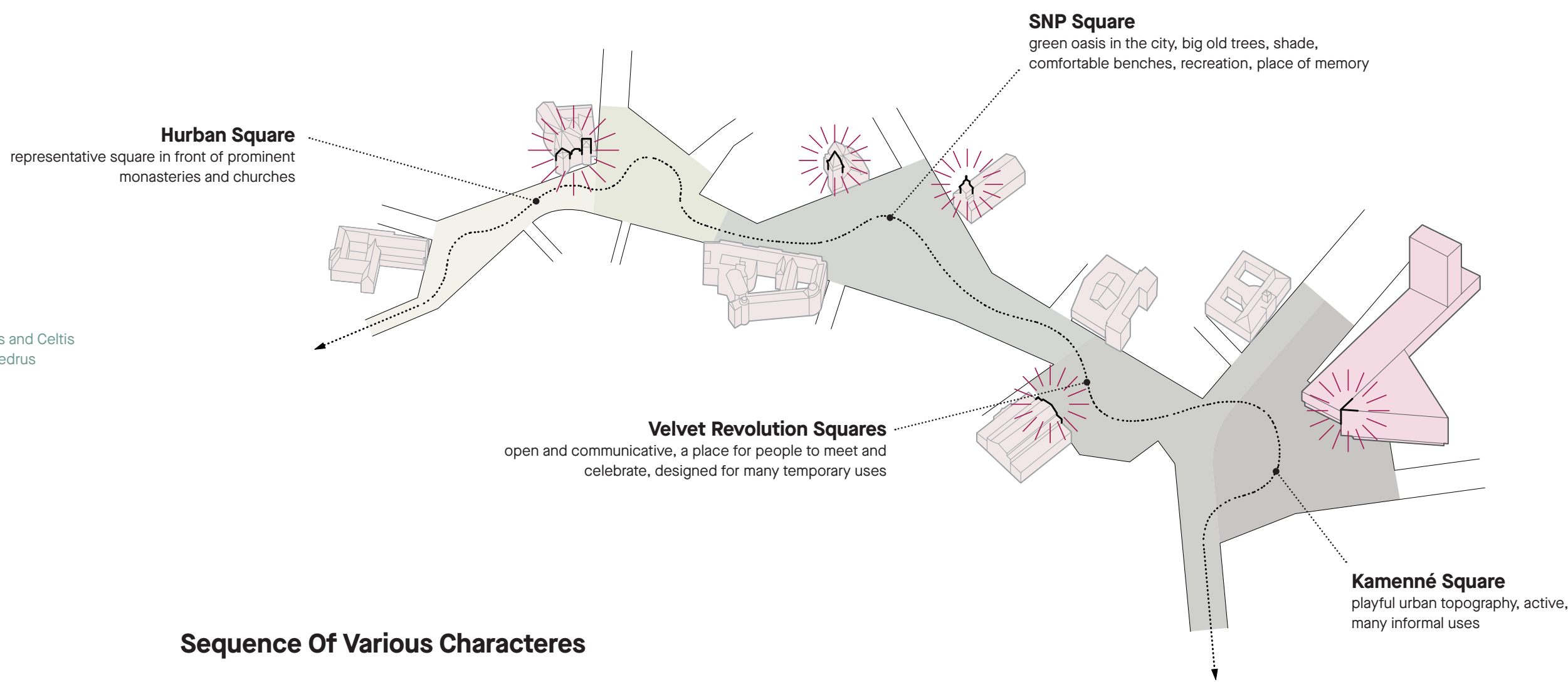

### Sequence Of Various Characteres

Each square has its own character, attractions and program and varies slightly in its atmosphere. The diversity can be explored in the way of a 'walkable city'.

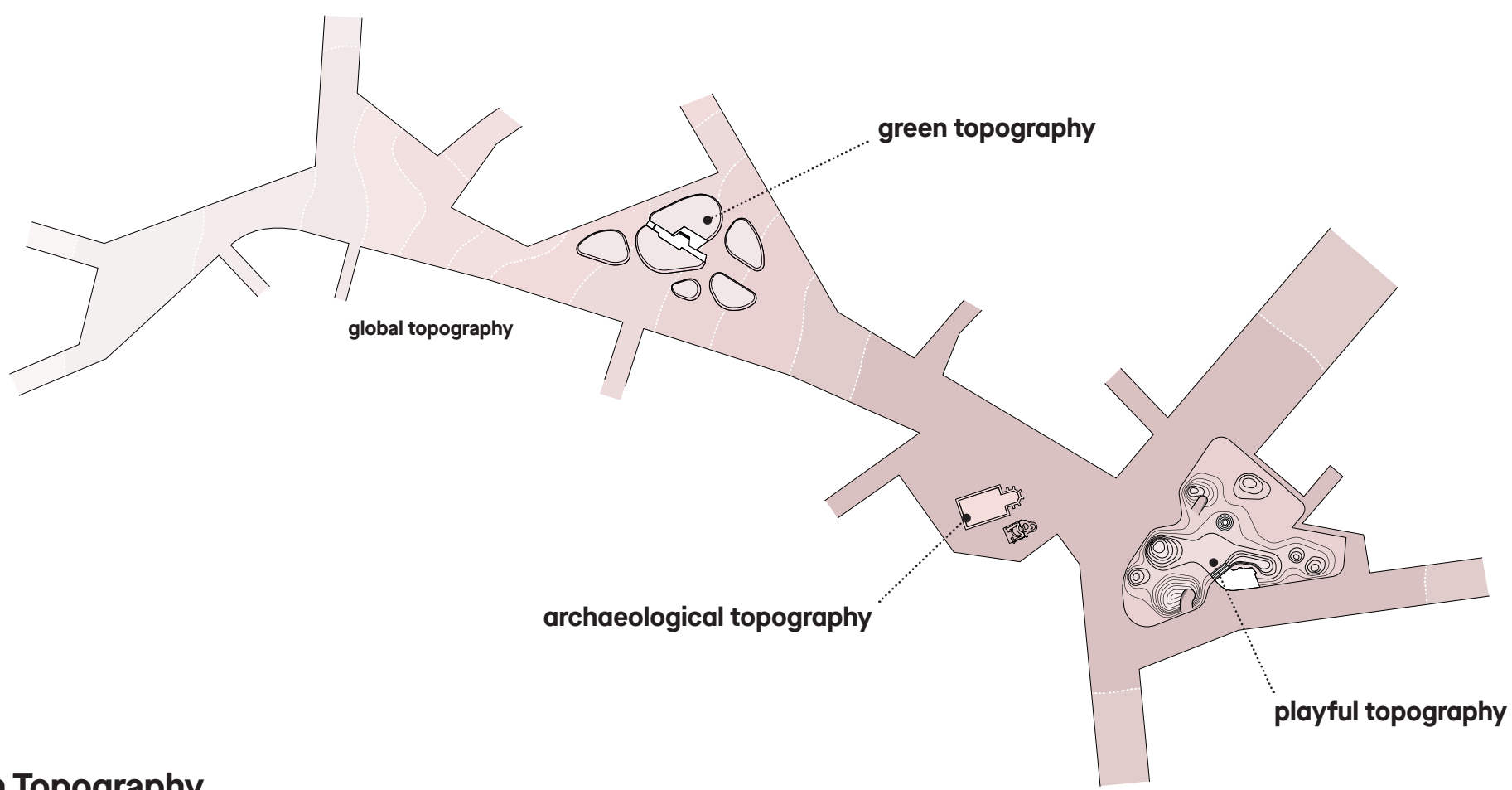

### Diverse Urban Topography

The three squares are thematically connected by topography and program. Topography creates various spaces to comfort everyone. Program animates for multiple activities. Thus the city becomes an inspiring and livable space.

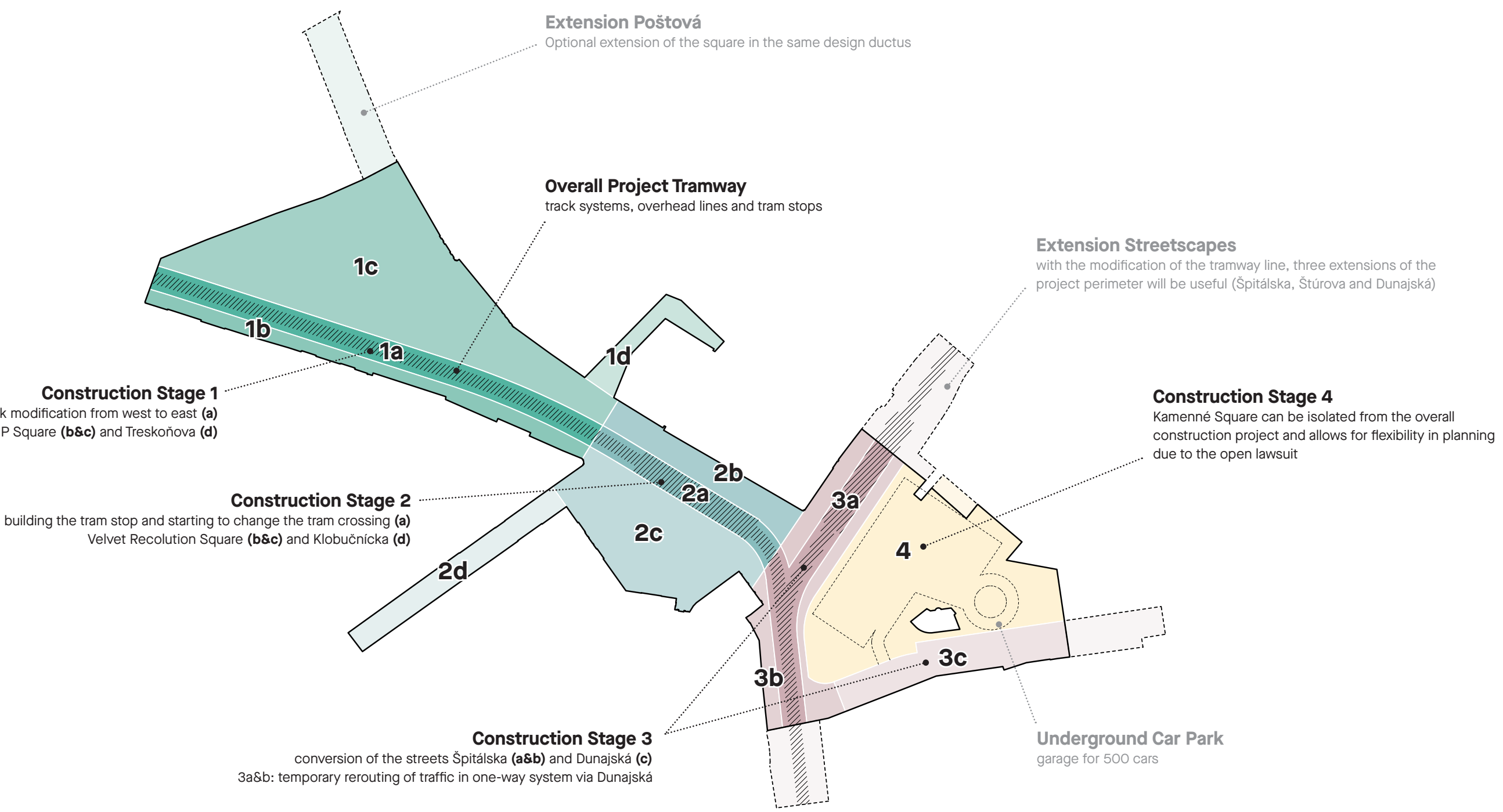

## An adaptable framework and high-quality materials for a resilient design

The open space framework needs to be as robust and simple as possible to allow resilience. We chose a continuous high-quality pavement of a regional natural stone that increases the durability of the SNP Square and Velvet Revolution Square including the street scape. Barriers, such as curbstones or steps, are eliminated. Thus the appearance of a floating space is strengthened. In addition, it is attractive in everyday life and can be used for many temporary or informal events.

Unified, timeless furniture creates a coherent impression of the squares. The standard format of the benches, bicycle stands and lights allows standardized repairs and minimizes the need for spare parts. The furniture can also be used on the other squares along the Old Town Loop.



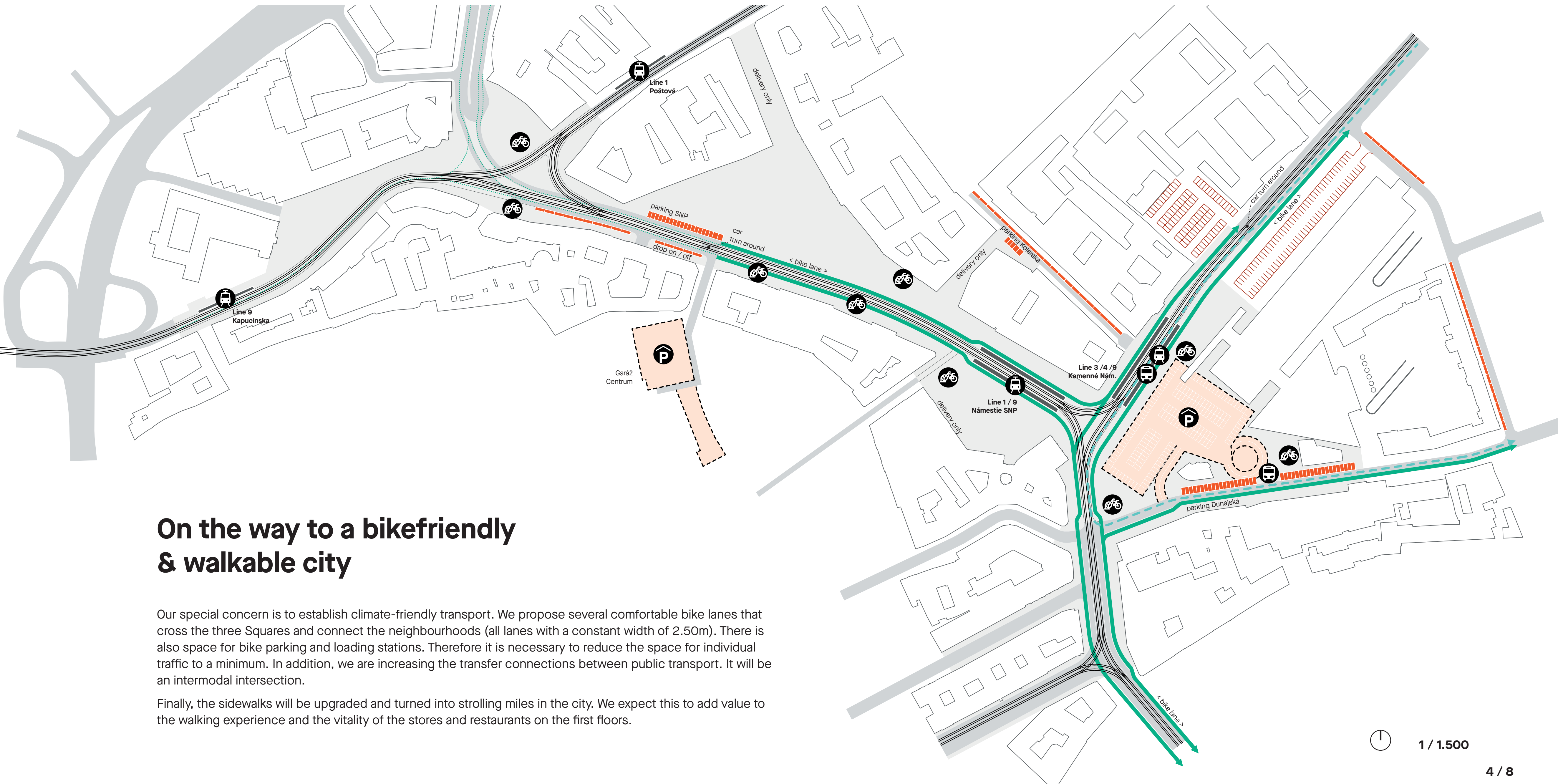

## On the way to a bikefriendly & walkable city

Our special concern is to establish climate-friendly transport. We propose several comfortable bike lanes that cross the three Squares and connect the neighbourhoods (all lanes with a constant width of 2.50m). There is also space for bike parking and loading stations. Therefore it is necessary to reduce the space for individual traffic to a minimum. In addition, we are increasing the transfer connections between public transport. It will be an intermodal intersection.

Finally, the sidewalks will be upgraded and turned into strolling miles in the city. We expect this to add value to the walking experience and the vitality of the stores and restaurants on the first floors.



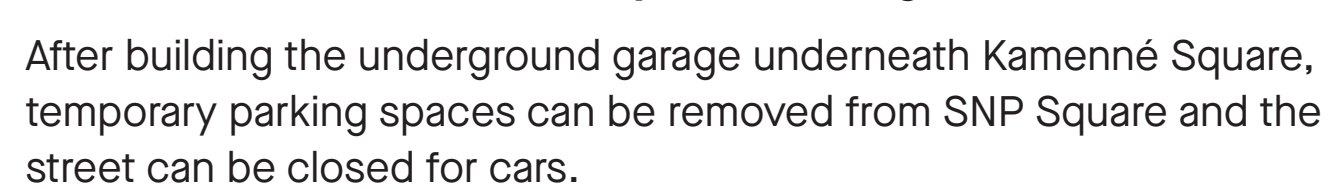
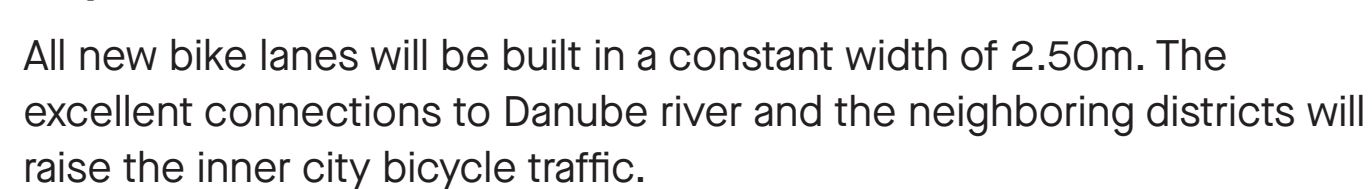
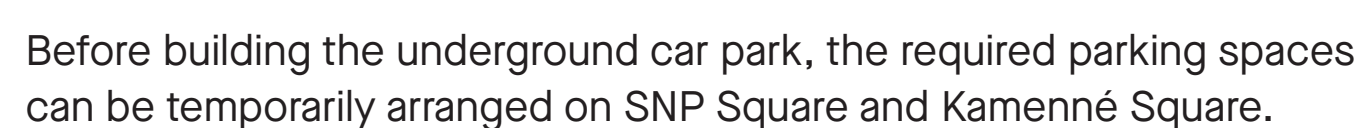
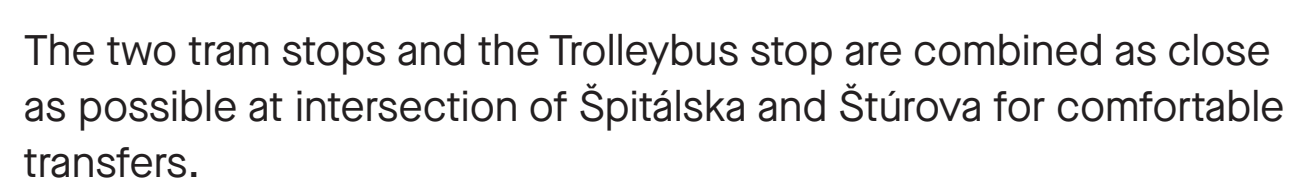
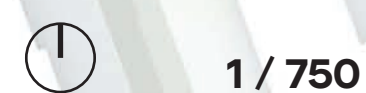



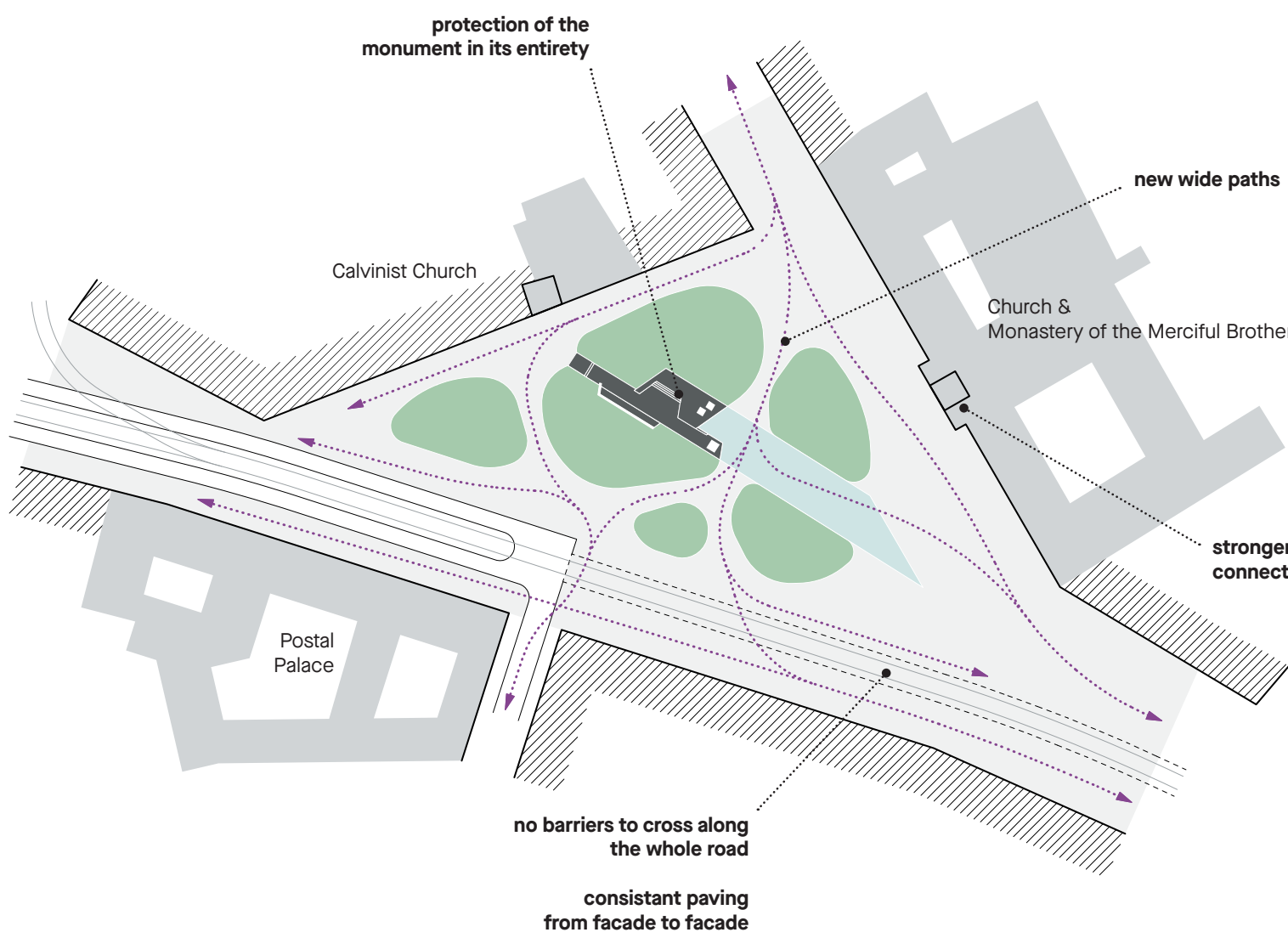
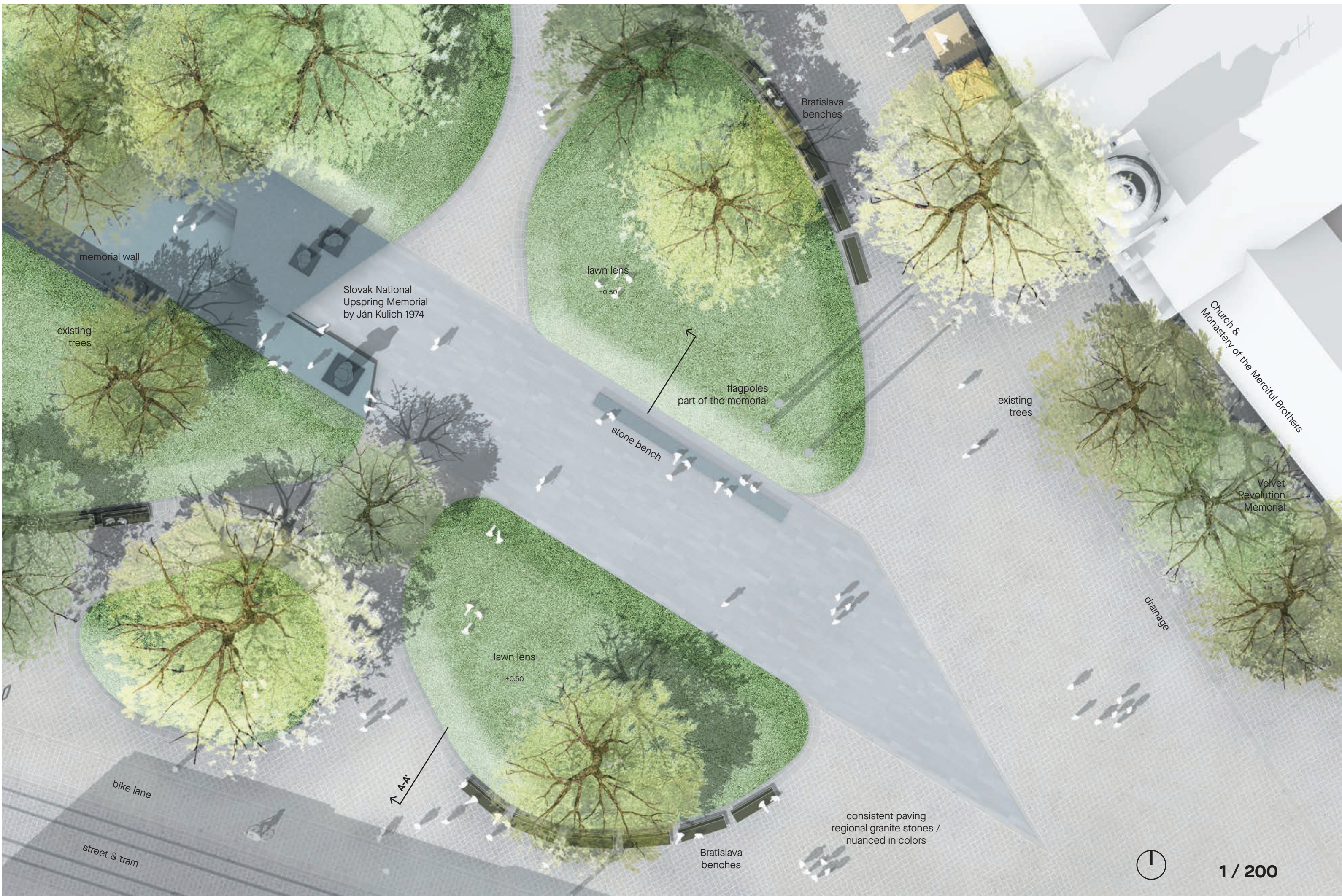

## SNP Square

### A place of remembrance & recreation

The SNP Square will be transformed into a site that offers both recreation and remembrance. The structure, which is centered around the memorial, is divided by impressive walking paths into a topography of lawn lenses of different sizes. Its gentle topography forms areas with long curved benches that motivate people to meet and relax. This rich offer of additional paths and recreational opportunities and niches make the square appear larger.

The reshaping of the lawn topography does not change the „Slovak National Uprising Memorial“ in its appearance and charisma. Ceremonial events, such as wreath-laying ceremonies, will still be possible in the future.

New views are created by removing the low branches of the tree population. The beautiful facades, restaurants and churches with their towers are now part of the vitality of the square.



The SNP monument is carefully embedded in the design and thus becomes part of the square and everyday life. The elevated lawn islands give orientation and guide visitors to the memorial. Long, comfortable benches encourage people to stay a while.





In the evening hours the market square is transformed into a lively meeting-point. With the relocation of the tram stop, the square can be enlarged and barriers can be removed. The combination of formal round benches and free furniture allows everyone to find a place under the large trees.

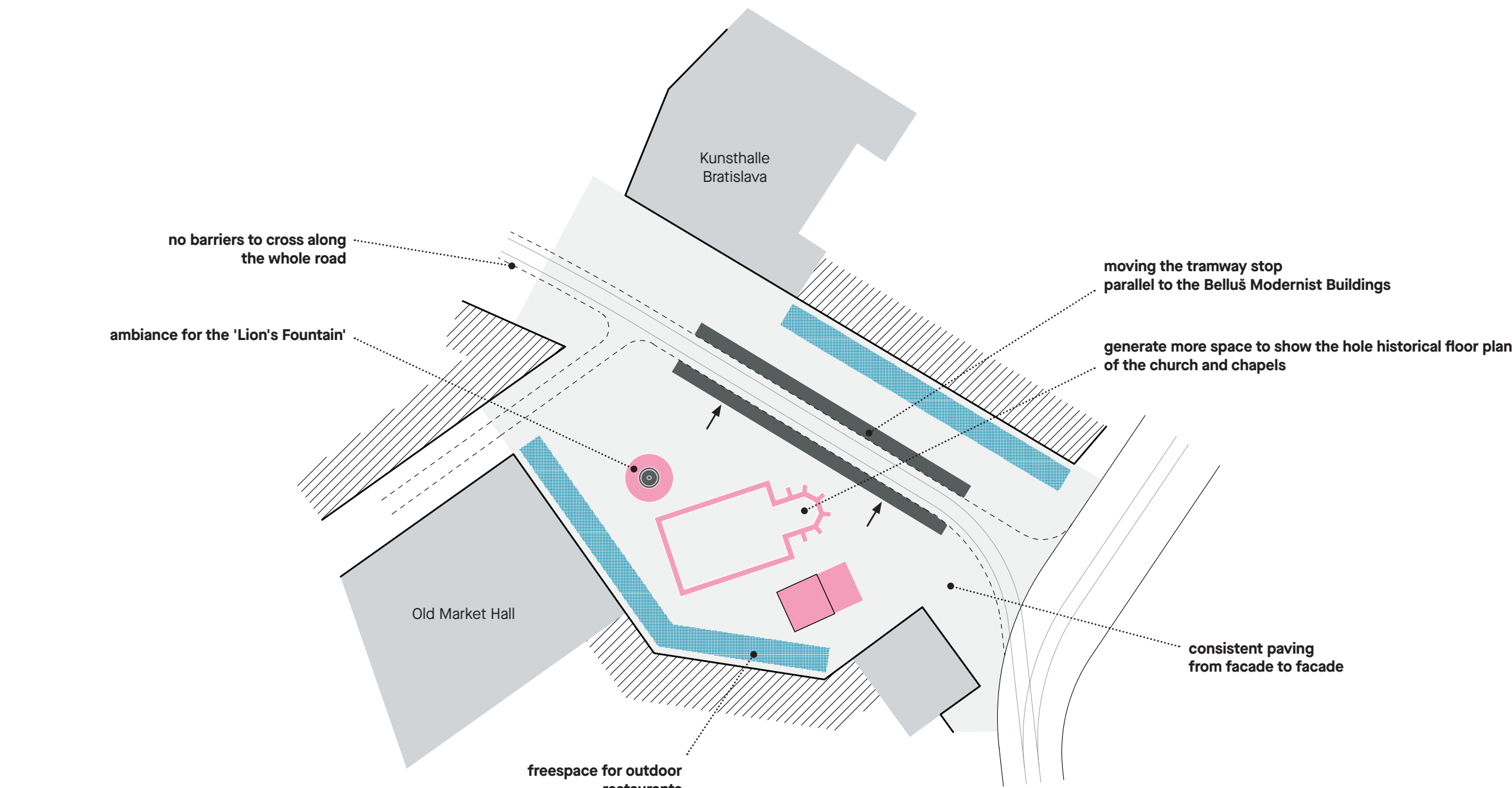
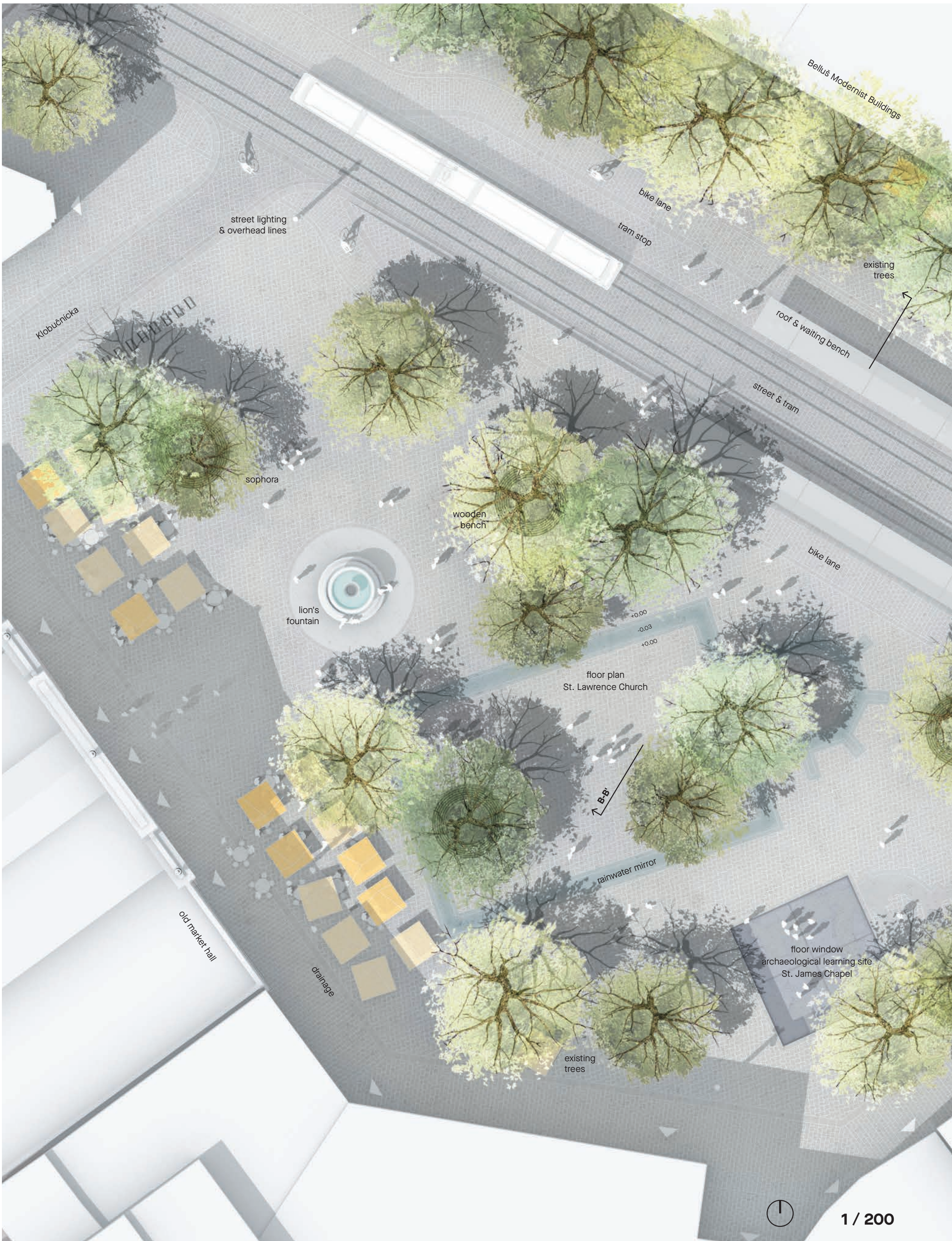

## Velvet Revolution Square

### Meeting place of urban life

The relocation of the tramway stop parallel to the „Bellus Modernist Buildings“ offers the chance to expand the space in front of the market hall. With this modification, the archaeological windows are given their appropriate space, and a generous, multi-use marketplace is created.

The number of trees will be increased. The shimmering of boughs and leaves, the combination of light, shadow and color creates a natural atmosphere that changes throughout the day and the seasons. The clear open square thus receives a pleasant affective atmosphere that invites you to stay.

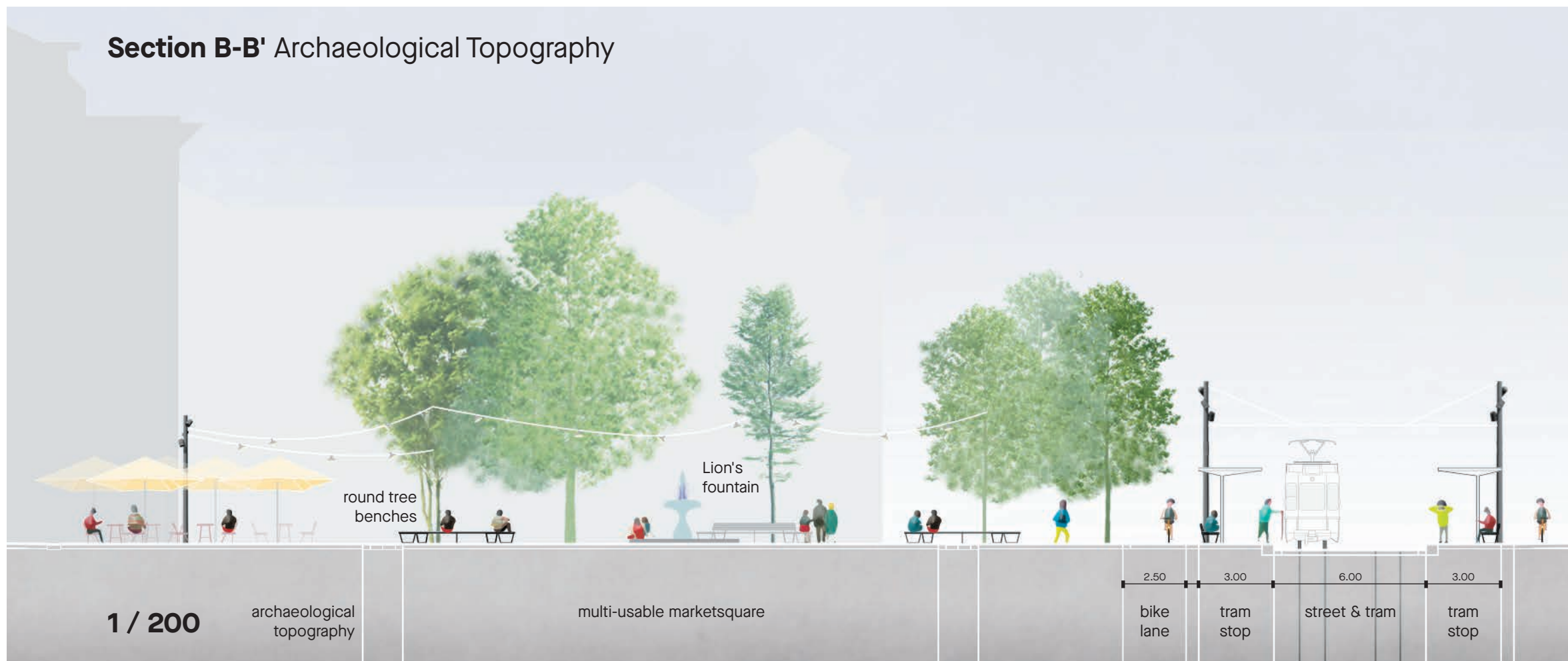





The formerly fragmented square is now occupied by a large, uniform ground relief. Its topography is both playful and impressive. On an average day the square would just be an informal stage, but it may also be used for special events. Lush, maybe even wild trees and plants contrast with the paved, urban topography.

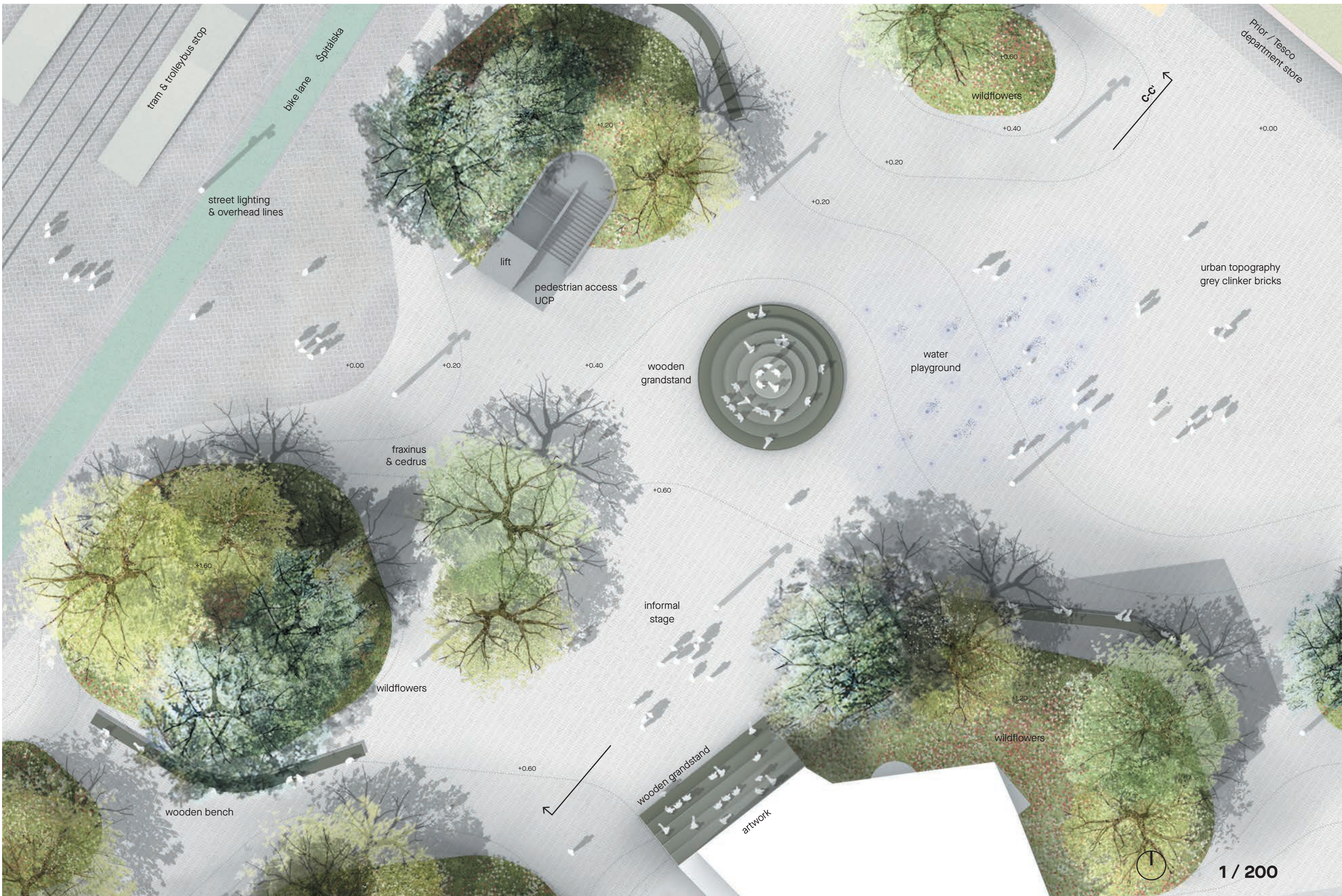

## Kamenné Square Vibrant heart of the neighborhood

The current situation is characterized by mobility barriers, an obvious desire for green and a lack of program and communicative elements. We want to create an urban topography as multiple space. The topography is barrier-free in the main pedestrian routes. At its peaks garage exits are hidden and sufficient root-space is accomplished.

Lush, maybe even wild trees and plants contrast with the paved topography. This will meet the desire for green in the stony city centre and improve the microclimate.

Various urban functions gather around an imaginary stage and activate the district and its community. On an average day the stage would just be informal, but it may also be used for special events.

